

R23 Series High Flow Pressure Regulators

FEATURES

- Single-stage diaphragm structure
- Corrugated diaphragm design for excellent sensitivity and cycle life
- Purity up to 6.0, inlet pressure 0~500 psi, outlet pressure 0~150 psi;
- Suitable for inert, corrosive, toxic, flammable, and combustible gases.

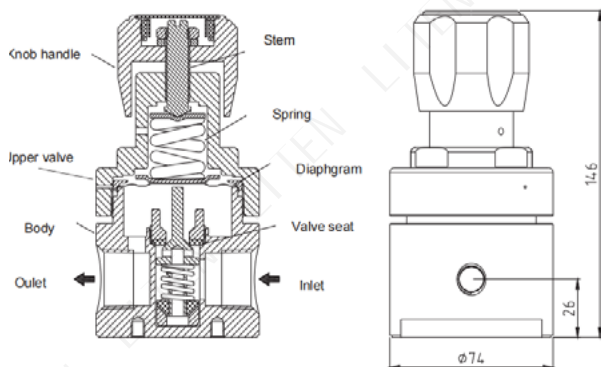

Internal structure

External dimension

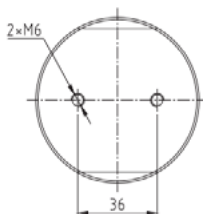

Middle opening, bottom mounting holes



- Valve seat material: PCTFE, PTFE
- Diaphragm material: SS316L, Hastelloy
- Female thread: 3/4"NPT(F)
- Leakage rate: 2×10^{-8} atm.cc/sec He

- Cv value: 1.8
- Valve body weight: 2.7kg
- Applicable temperature: -40 °C to +74 °C
- Safety pressure: 1.5 times the maximum input pressure

FLOW DATA

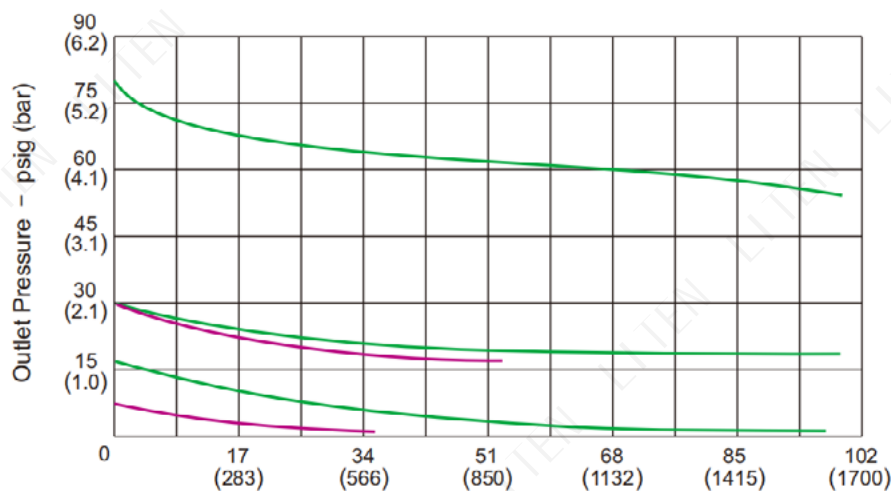

Inlet Pressure - psig (bar)
 — 500 (34.5)
 — 200 (13.8)

R23 Series High Flow Pressure Regulators

CLEANING TECHNICS

Standard(WK-BA)

The welded fittings are cleaned in accordance with our standard cleaning and packaging specifications.
No suffixes need to be added when ordering.

Oxygen Cleaning(WK-O2)

Specifications for cleaning and packaging of products for oxygen environments are available.
This meets ASTM G93 Class C cleanliness requirements. When ordering, add -O2 to the end of the order number.

PORT CONFIGURATIONS

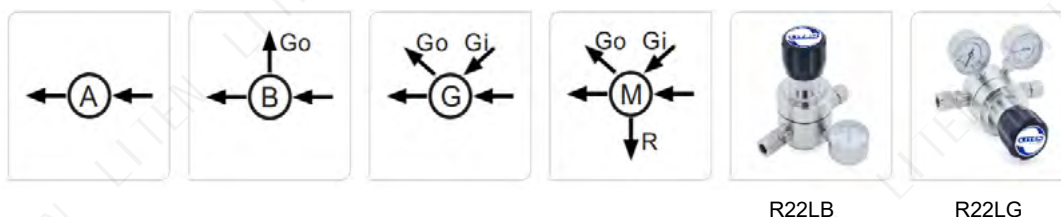

For more or additional port options, please consult LITEN.

ORDERING INFORMATION

Series	Body Material	Body Port	Inlet Pressure	Outlet Pressure	Pressure Gauges	Inlet Connection	Outlet Connection	Optional Accessories
R23	L	A	-K	D	G	-00	-00	-R
R23	L:316L	A	K:500psi	D:0~150psi	G:MPa	05:1/2"NPT(M)	05:1/2"NPT(M)	R: Safety valve
	B: Brass	B		C:0~100psi	P:psi/bar	06:3/4"NPT(F)	06:3/4"NPT(F)	P: Center-mounted
		G		B:0~50psi	W: No Gauges	12:3/8"OD	12:3/8"OD	F: Fixed panel
		M		A:0~25psi		13:1/2"OD	13:1/2"OD	None
						14:3/4"OD	14:3/4"OD	
						More.....	More.....	

Note: For more model selections, please contact LITEN.

OPTIONAL ACCESSORIES



Safety Valve

Pressure Gauge

Connectors

Fixed Panel